



Gland Adaptor  
F-4617-##

425 Amp Series

Ordering Procedure

- 1 Select complete Gland Adaptor from Table 1

Table 1

Part Number	Description
F-4617-25	Gland Adaptor (M25 entry thread)
F-4617-32	Gland Adaptor (M32 entry thread)
F-4617-40	Gland Adaptor (M40 entry thread)
F-4617-50	Gland Adaptor (M50 entry thread)
F-4617-63	Gland Adaptor (M63 entry thread)
F-4617-75	Gland Adaptor (M75 entry thread)
F-4617-85	Gland Adaptor (M85 entry thread)
F-4617-95	Gland Adaptor (M95 entry thread)
F-4617-110	Gland Adaptor (M110 entry thread)

Spare Parts

#	Part Number	Description
1	AI019010	O-ring ID 120.24 x sect. 3.53
2		Earth Strap
3	AH113091	Screw M8 x 10 hex. head
4	AH009363	Spring Washer 5/16"
5	AH009277	Washer 5/16"
6	AH151038	Screw M12 x 60 hex. head
7	AH120012	Nut M12

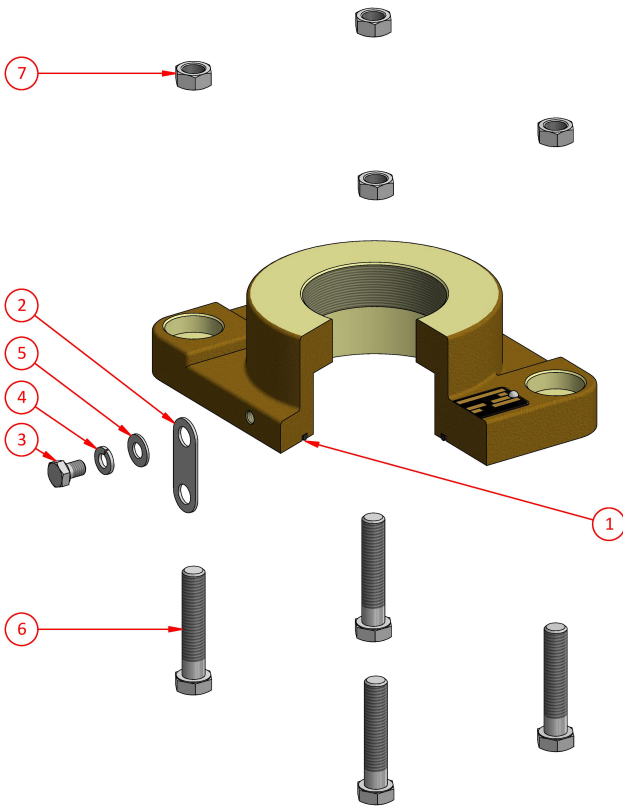

Weight 7kg  
 Dimensions L 220mm W 180mm H 80mm  
 Compliance Explosion protected to AS/NZS1299 & IEC60079 Series  
 Materials Manganese Bronze  
 IP Rating IP66/68

CMI Head Office NSW | (02) 9807 6155 | F3, 3-29 Birnie Ave, Lidcombe, NSW, 2141 | nswsales@cmielectrical.com.au  
 CMI QLD-Brisbane (07) 3863 0749 485A Zillmere Road, Zillmere QLD 4034 southqdsales@cmielectrical.com.au  
 CMI QLD - Rockhampton (07) 4921 0978 Shop 3 at 76 Hollingsworth Street, North Rockhampton Qld 4701 northqdsales@cmielectrical.com.au

CMI VIC (03) 9532 1233 3 Dissik Street, Cheltenham VIC 3192 vicsales@cmielectrical.com.au

CMI WA (08) 9358 1788 36 Division Street, Welshpool WA 6106 wasales@cmielectrical.com.au