



Gland Adaptor  
 F-4617-##

300 Amp Series

Ordering Procedure

1

Select complete Gland Adaptor from Table 1

Table 1

| Part Number | Description                       |
|-------------|-----------------------------------|
| F-4617-25   | Gland Adaptor (M25 entry thread)  |
| F-4617-32   | Gland Adaptor (M32 entry thread)  |
| F-4617-40   | Gland Adaptor (M40 entry thread)  |
| F-4617-50   | Gland Adaptor (M50 entry thread)  |
| F-4617-63   | Gland Adaptor (M63 entry thread)  |
| F-4617-75   | Gland Adaptor (M75 entry thread)  |
| F-4617-85   | Gland Adaptor (M85 entry thread)  |
| F-4617-95   | Gland Adaptor (M95 entry thread)  |
| F-4617-110  | Gland Adaptor (M110 entry thread) |

Spare Parts

| # | Part Number | Description                   |
|---|-------------|-------------------------------|
| 1 | AI019010    | O-ring ID 120.24 x sect. 3.53 |
| 2 |             | Earth Strap                   |
| 3 | AH113091    | Screw M8 x 10 hex. head       |
| 4 | AH009363    | Spring Washer 5/16"           |
| 5 | AH009277    | Washer 5/16"                  |
| 6 | AH151038    | Screw M12 x 60 hex. head      |
| 7 | AH120012    | Nut M12                       |

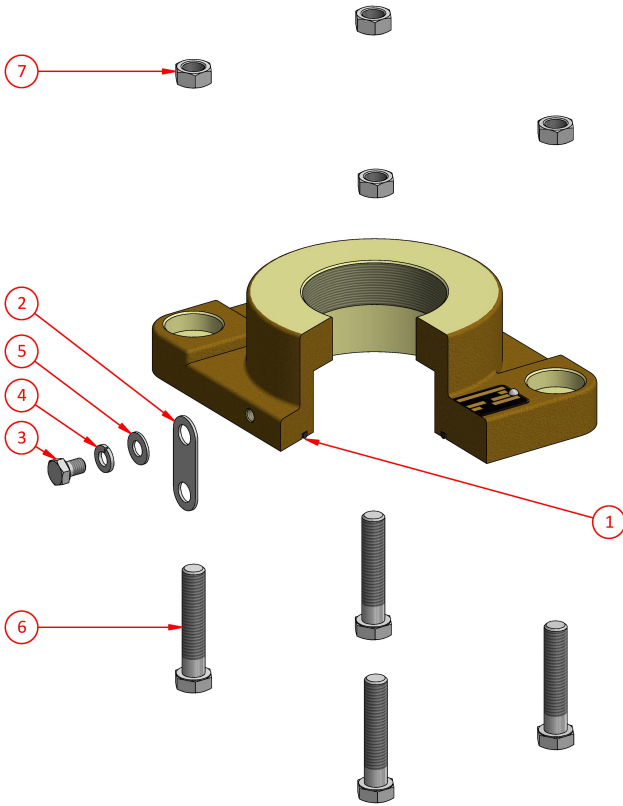

Weight 7kg  
 Dimensions L 220mm W 180mm H 80mm  
 Compliance Explosion protected to AS/NZS1299 & IEC60079 Series  
 Materials Manganese Bronze  
 IP Rating IP66/68

CMI Head Office NSW | (02) 9807 6155 | F3, 3-29 Birnie Ave, Lidcombe, NSW, 2141 | nswsales@cmielectrical.com.au  
 CMI QLD-Brisbane (07) 3863 0749 485A Zillmere Road, Zillmere QLD 4034 southqdsales@cmielectrical.com.au  
 CMI QLD - Rockhampton (07) 4921 0978 Shop 3 at 76 Hollingsworth Street, North Rockhampton Qld 4701 northqdsales@cmielectrical.com.au

CMI VIC (03) 9532 1233 3 Dissik Street, Cheltenham VIC 3192 vicsales@cmielectrical.com.au

CMI WA (08) 9358 1788 36 Division Street, Welshpool WA 6106 wasales@cmielectrical.com.au