

Ordering Procedure

1

Select complete Accessory from Table 1

Table 1

Part Number	Description
F-4479B	800A Blanking Cover
F-829-1	800A Pilot Connecting Pin
F-800	800A Phase Connecting Socket
F-810	800-150A Phase Transition Connecting Pin
F-830	800-300A Phase Transition Connecting Pin
F-840	800-425A Phase Transition Connecting Pin
3766-1	Socket Extraction Tool
4534	800A Connecting Socket Extraction Tool
AH113116S	Screw M10 x 50 hex. head
AH120019	M10 Nut
MO4645	Blanking Cover Insulator

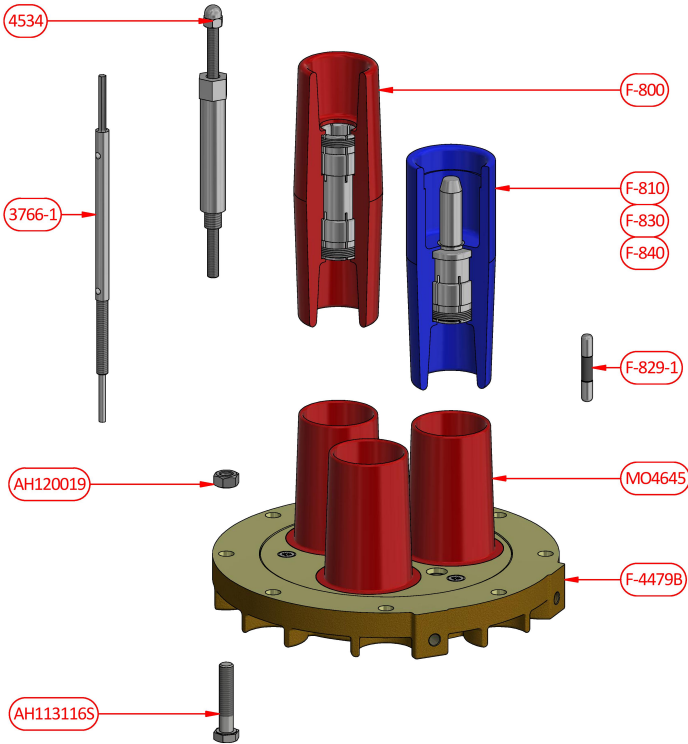

Compliance
Materials

Explosion protected to AS/NZS1300 & IEC60079 Series
 Manganese Bronze / Silicone Rubber / Silver Plated Copper

CMi Head Office NSW | (02) 9807 6155 | F3, 3-29 Birnie Ave, Lidcombe, NSW, 2141 | nswsales@cmielectrical.com.au
CMi QLD-Brisbane
 (07) 3863 0749
 485A Zillmere Road,
 Zillmere QLD 4034
southqdsales@cmielectrical.com.au

CMi QLD - Rockhampton
 (07) 4921 0978
 Shop 3 at 76 Hollingsworth Street,
 North Rockhampton Qld 4701
northqdsales@cmielectrical.com.au

CMi VIC
 (03) 9532 1233
 3 Dissik Street,
 Cheltenham VIC 3192
vicsales@cmielectrical.com.au

CMi WA
 (08) 9358 1788
 36 Division Street,
 Welshpool WA 6106
wasaales@cmielectrical.com.au