

Bolted Coupler
AA364T - AA314T
AA464T - AA414T

300/425 Amp Series B

Body Size B - 660V - 1100V

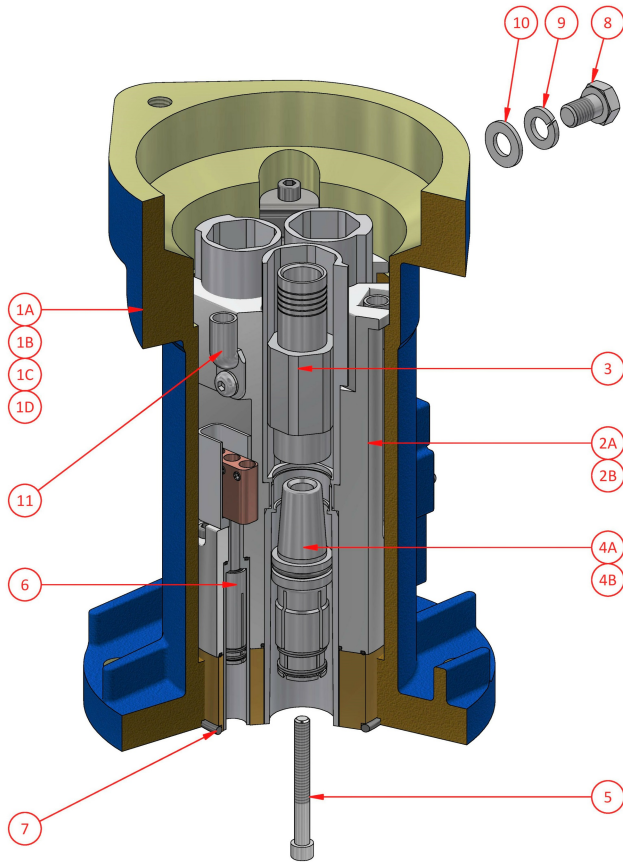

Weight 12.0kg
Dimensions L 200mm W 210mm H 280mm
Compliance Explosion protected to IEC60079 Series
Materials Manganese Bronze / Brass / Aluminium / PTFE
IP Rating IP66

Ordering Procedure

- 1 Select complete Coupler from Table 1
- 2 Select Phase Thimble from Table 2 (3 Required)
- 3 Select Gland from No.2 to No.5 Glands
- 4 Select Accessories from Body Size B Accessories

Table 1

Part Number	Description	Colour
AA364T	300A 660V Bolted Coupler	Orange
AA314T	300A 1100V Bolted Coupler	Blue
AA464T	425A 660V Bolted Coupler	Orange/Silver
AA414T	425A 1100V Bolted Coupler	Blue/Silver

NB: Coupler supplied with Pilot Thimble

Table 2

Phase Thimble - c/w screw AH009868 1/4" x 2 1/4" skt. head

Part Number	CSA	ID mm	Utilux Die No.
F-201-432	25	8.0	38-92 Cu
F-201-302	35	9.5	38-115 Cu
F-201-303	50	10.5	38-115 Cu
F-201-303-1	70	12.8	38-142 Cu
F-201-304-1	95	14.0	38-165 Cu
F-201-305-1	120	16.0	38-165 Cu
F-201-306-1	150	18.0	38-183 Cu
F-201-307-1	185	21.8	38-231 Cu
F-201-326-1	240	24.2	SOLDER ONLY

NB: CSA is indicative only. Use ID for thimble selection

Spare Parts

#	Part Number	Description
1A	F-3432-364T	300A 660V Coupler Body c/w items 1A, 7, 8, 9 & 10
1B	F-3432-314T	300A 1100V Coupler Body c/w items 1B, 7, 8, 9 & 10
1C	F-3432-464T	425A 660V Coupler Body c/w items 1C, 7, 8, 9 & 10
1D	F-3432-414T	425A 1100V Coupler Body c/w items 1D, 7, 8, 9 & 10
2A	F-4812	Interior c/w Earth Lugs, Screws, Pilot Socket Assy & Retaining Bracket
2B	F-4812KIT	Interior Service Kit c/w Insulators & O-rings
3	See Table 2	Phase Thimble
4A	F-201-299	300A Phase Socket c/w O-ring AI019013
4B	F-201-300-1	425A Phase Socket c/w O-ring AI019013
5	AH009868	Screw 1/4" x 2 1/4" skt. head
6	F-4819	Pilot Socket Assy c/w O-ring AI019065 & Pilot Thimble
7	AI019006	O-ring ID 82.14 x sect. 3.53
8	AH113111	Screw M10 x 16 hex. head
9	AH151011	Spring Washer M10
10	AH150011	Washer M10
11	F-AH017206B	Earth Lug c/w screw AH115115 & washer AH150014

CMI Head Office NSW | (02) 9807 6155 | F3, 3-29 Birnie Ave, Lidcombe, NSW, 2141 | nswsales@cmielectrical.com.au
CMI QLD-Brisbane
(07) 3863 0749
485A Zillmere Road,
Zillmere QLD 4034
southqdsales@cmielectrical.com.au

CMI QLD - Rockhampton
(07) 4921 0978
Shop 3 at 76 Hollingsworth Street,
North Rockhampton Qld 4701
northqdsales@cmielectrical.com.au

CMI VIC
(03) 9532 1233
3 Dissik Street,
Cheltenham VIC 3192
vicsales@cmielectrical.com.au

CMI WA
(08) 9358 1788
36 Division Street,
Welshpool WA 6106
wasales@cmielectrical.com.au