

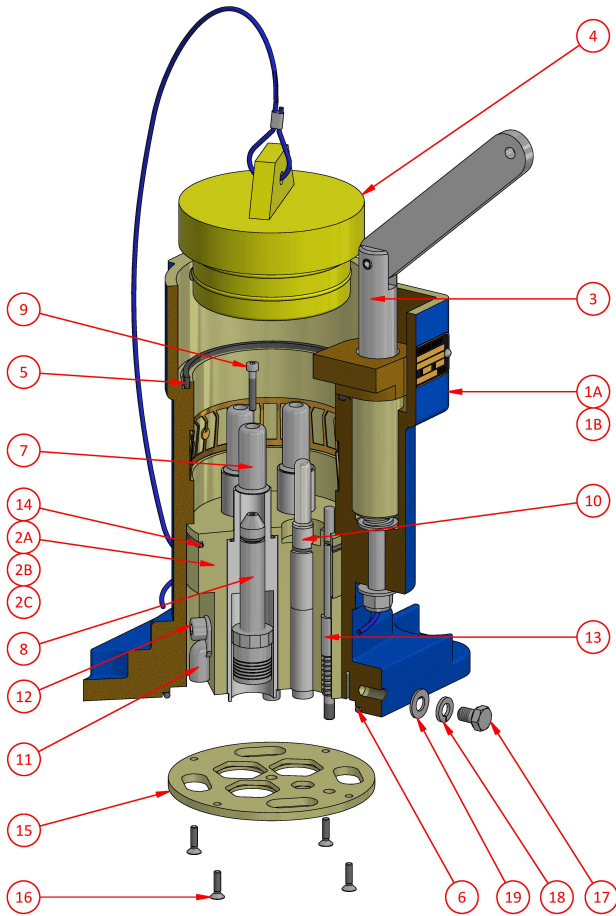

Receptacle
AG364B - AG314B

300 Amp Series

660V - 1100V



Receptacle shown fitted with "Optional" Actuator

Weight 19kg
Dimensions L 220mm W 220mm H 330mm
Compliance Explosion protected to AS/NZS1299 & IEC60079 Series
Materials Manganese Bronze / Brass / PTFE
IP Rating IP66/68

Ordering Procedure

- 1 Select complete Receptacle from Table 1
- 2 Select Phase Thimble from Table 2 (3 Required)
- 3 Add Part No. from Table 1 & Options Table together to get Part No. required if an Actuator is needed

Table 1



| Part Number | Description | Colour |
|-------------|-----------------------------|--------|
| AG364B | 660V Restrained Receptacle | Orange |
| AG314B | 1100V Restrained Receptacle | Blue |

NB: Receptacle supplied with Pilot Thimble

Table 2

Phase Thimble - c/w screw AH151026 & O-ring AI019017

| Part Number | CSA | ID mm | Utilux Die No. |
|-------------|-----|-------|----------------|
| F-4606-1 | 35 | 8.4 | 38-92 Cu |
| F-4606-2 | 50 | 9.5 | 38-104 Cu |
| F-4606-3 | 70 | 11.2 | 38-115 Cu |
| F-4606-4 | 95 | 13.4 | 38-142 Cu |
| F-4606-5 | 120 | 15.5 | 38-165 Cu |
| F-4606-6 | 150 | 16.3 | 38-183 Cu |
| F-4606-7 | 185 | 18.4 | 38-200 Cu |
| F-4606-8 | 185 | 21.0 | 38-210 Cu |

NB: CSA is indicative only. Use ID for thimble selection

Options

| Part Number | Description |
|-------------|-------------|
| A | Actuator |

Example: AG364BA

Spare Parts

| # | Part Number | Description |
|----|----------------------|--|
| 1A | | 660V Receptacle Body c/w items 1A, 3, 5, 6, 18, 19 & 20 |
| 1B | | 1100V Receptacle Body c/w items 1B, 3, 5, 6, 18, 19 & 20 |
| 2A | F-4602 | Interior c/w O-ring, Earth Lugs, Retaining Plate & Screws |
| 2B | F-4602A | Interior c/w O-ring, Actuator, Earth Lugs, Retaining Plate & Screws |
| 2C | F-4602KIT(300A-4PIN) | Interior Service Kit c/w O-rings, Insulators, Pilot Pin Assy, Retaining Plate & Screws |
| 3 | 3401B | Jacking Screw |
| 4 | F-311 | Sealing Plug |
| 5 | 4401-3 | Seal |
| 6 | AI019010 | O-ring ID 120.24 x sect. 3.53 |
| 7 | | Phase Pin |
| 8 | See Table 2 | Phase Thimble |
| 9 | AH151026 | Screw M4 x 25 skt. head |
| 10 | F-853-1 | Pilot Pin & Thimble Assembly c/w Insulator & O-ring |
| 11 | AH017206 | Earth Lug |
| 12 | AH151027 | Screw M8 x 12 skt. head |
| 13 | F-4618 | Actuator c/w O-ring AI019051 & Spring 4619 |
| 14 | AI019048 | O-ring ID 94.92 x sect. 2.62 |
| 15 | 4612 | Interior Retaining Plate |
| 16 | AH151022 | Screw M4 x 16 csk. head |
| 17 | AH113091 | Screw M8 x 10 hex. head |
| 18 | AH009363 | Spring Washer 5/16" |
| 19 | AH009277 | Washer 5/16" |