



Receptacle Quick Release
AG164BQR - AG114BQR

150 Amp Series

660V - 1100V

Ordering Procedure

- 1 Select complete Receptacle from Table 1
- 2 Select Phase Thimble from Table 2 (3 Required)
- 3 Add Part No. from Table 1 & Options 2 Table together to get Part No. required (See examples shown under the Options 2 Table)

Table 1



Part Number	Description	Colour
AG164BQR	660V Restrained Receptacle Quick Release	Orange
AG114BQR	1100V Restrained Receptacle Quick Release	Blue

NB: Receptacle supplied with Pilot Thimble. Key Lock as shown is not supplied.

Table 2

Phase Thimble - screw AH151021 M4 x 40 skt. head

Part Number	CSA	ID mm	Utilux Die No.
F-4626	6	3.7	38-44 Cu
F-4626-0	16	5.5	38-63 Cu
F-4626-1	25	7.1	38-77 Cu
F-4626-2	35	8.4	38-92 Cu
F-4626-3	50	9.5	38-104 Cu
F-4626-4	70	11.2	38-115 Cu
F-4626-5	95	13.4	38-142 Cu

NB: CSA is indicative only. Use ID for final selection

Options 1

Earth Thimble - c/w AH151037 M6 x 12 csk. head

Part Number	Cable Acceptance mm	ID mm	Utilux Die No.
F-4648S	10	4.7	38-57 Cu
F-4648-1S	16	5.5	38-63 Cu
F-4648-2S	25	7.1	38-77 Cu
F-4648-3S	35	8.4	38-92 Cu
F-4648-4S	50	10.0	Solder Only

NB: F-4648-2S supplied with Receptacle

Options 2

Part Number	Description
F	Bracket for Front Key Operated Locking Mechanism
S	Bracket for Side Key Operated Locking Mechanism
L	Lockable Hasp

Example: AG164BQRFF, AG164BQRSS, AG164BQRLL

Spare Parts

#	Part Number	Description
1A	F-3184QR-164	660V QR Receptacle Body c/w items 1A, 3A, 4, 5, 8, 9, 18, 19 & 20
1B	F-3184QR-114	1100V QR Receptacle Body c/w items 1B, 3A, 4, 5, 8, 9, 18, 19 & 20
2A	F-4621	Interior c/w O-Ring, Earth Thimble, Retaining Plate & Screws
2B	F-4621KIT	Interior Service Kit c/w O-Rings, Insulators, Pilot Pin Assy, Retaining Plate & Screws
3A	F-459	Q/R Locking Mechanism c/w screws AH009860 1/4" x 1" skt. head
3B	F-459F	Q/R Locking Mechanism c/w Mounting Bracket (front key operated) & screws AH009860 1/4" x 1" skt. head
3C	F-459S	Q/R Locking Mechanism c/w Mounting Bracket (side key operated) & screws AH009860 1/4" x 1" skt. head
3D	F-459L	Q/R Locking Mechanism c/w Lockable Hasp & AH009860 1/4" x 1" skt. head
4	F-460	Q/R Rack
5	F-482	Q/R Pinion c/w Handle
6	4285	Q/R Handle
7	F-310	Sealing Plug
8	4401-2	Seal
9	AI019011	O-ring ID 91.67 x sect. 3.53
10	F-4623	Phase Pin c/w O-ring AI019001
11	See Table 2	Phase Thimble
12	AH151021	Screw M4 x 40 skt. head
13	F-854	Pilot Pin & Thimble Assembly c/w Insulator
14	F-4648-2S	Earth Thimble c/w screw AH151037 M6 x 12 csk. head
15	AI019003	O-ring ID 63.17 x sect. 2.62
16	4628	Interior Retaining Plate
17	AH151022	Screw M4 x 16 csk. head
18	AH113091	Screw M8 x 10 hex. head
19	AH009363	Spring Washer 5/16"
20	AH009277	Washer 5/16"

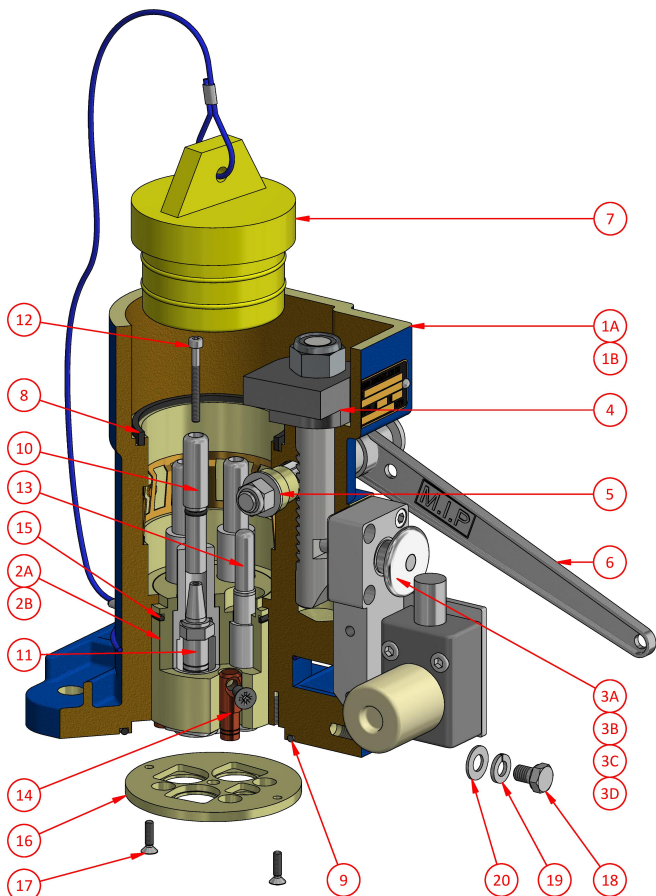

Receptacle shown fitted with "Optional" Side Key Operated Locking Mechanism

Weight 14kg
Dimensions L 250mm W 140mm H 270mm
Compliance Explosion protected to AS/NZS1299 & IEC60079 Series
Materials Manganese Bronze / Brass / PTFE
IP Rating IP66/68

CMI Head Office NSW | (02) 9807 6155 | F3, 3-29 Birnie Ave, Lidcombe, NSW, 2141 | nswsales@cmielectrical.com.au
CMI QLD-Brisbane
(07) 3863 0749
485A Zillmere Road,
Zillmere QLD 4034
southqdsales@cmielectrical.com.au

CMI QLD – Rockhampton
(07) 4921 0978
Shop 3 at 76 Hollingsworth Street,
North Rockhampton Qld 4701
northqdsales@cmielectrical.com.au

CMI VIC
(03) 9532 1233
3 Dissik Street,
Cheltenham VIC 3192
vic-sales@cmielectrical.com.au

CMI WA
(08) 9358 1788
36 Division Street,
Welshpool WA 6106
wasales@cmielectrical.com.au