



Gland Adaptor
F-4575-##

60 Amp Series

Ordering Procedure

1

Select complete Gland Adaptor from Table 1

Table 1

Part Number	Description
F-4575-20	Gland Adaptor (M20 entry thread)
F-4575-25	Gland Adaptor (M25 entry thread)
F-4575-32	Gland Adaptor (M32 entry thread)
F-4575-40	Gland Adaptor (M40 entry thread)
F-4575-50	Gland Adaptor (M50 entry thread)
F-4575-63	Gland Adaptor (M63 entry thread)

Spare Parts

#	Part Number	Description
1	AI019006	O-ring ID 82.14 x sect. 3.53
2		Earth Strap
3	AH113091	Screw M8 x 10 hex. head
4	AH009363	Spring Washer 5/16"
5	AH009277	Washer 5/16"
6	AH113099	Screw M8 x 50 hex. head
7	AH120009	Nut M8

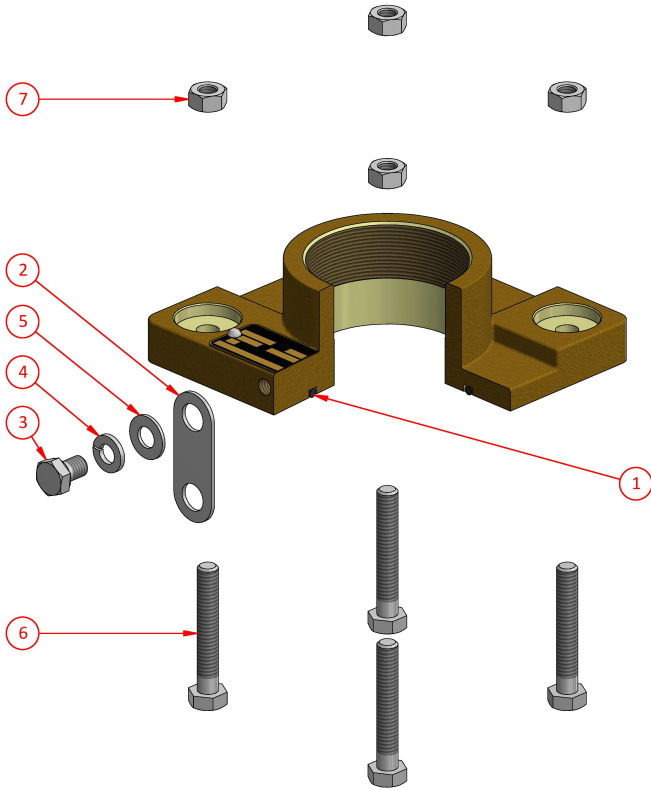

Weight 3kg
Dimensions L 180mm W 160mm H 70mm
Compliance Explosion protected to AS/NZS1299 & IEC60079 Series
Materials Manganese Bronze
IP Rating IP66/68

CMI Head Office NSW | (02) 9807 6155 | F3, 3-29 Birnie Ave, Lidcombe, NSW, 2141 | nswsales@cmielectrical.com.au
CMI QLD-Brisbane
 (07) 3863 0749
 485A Zillmere Road,
 Zillmere QLD 4034
 southqldsales@cmielectrical.com.au
CMI QLD - Rockhampton
 (07) 4921 0978
 Shop 3 at 76 Hollingsworth Street,
 North Rockhampton Qld 4701
 northqldsales@cmielectrical.com.au

CMI VIC
 (03) 9532 1233
 3 Dissik Street,
 Cheltenham VIC 3192
 vicsales@cmielectrical.com.au

CMI WA
 (08) 9358 1788
 36 Division Street,
 Welshpool WA 6106
 wasales@cmielectrical.com.au