

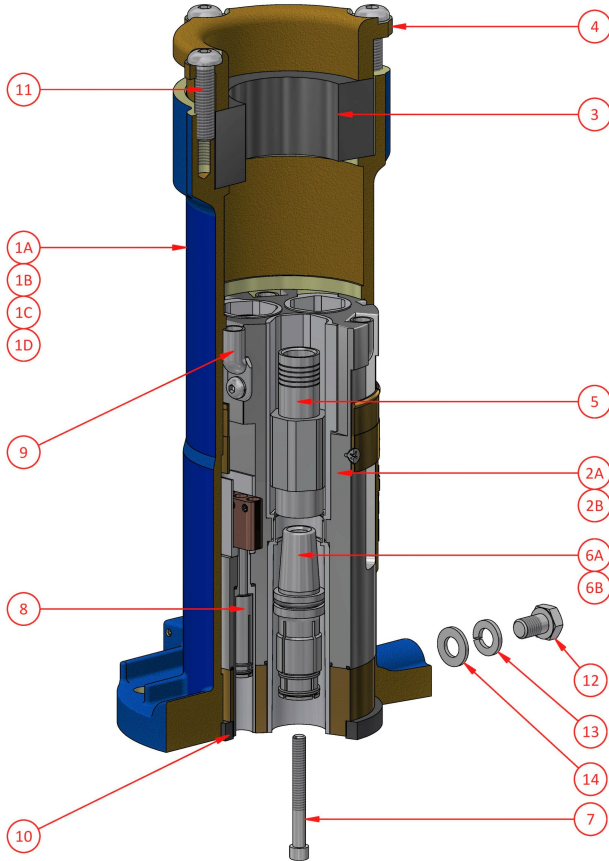

Bolted Coupler
 AA364T2 - AA314T2
 AA464T2 - AA414T2

300/425 Amp Series B

Body Size B - 660V - 1100V



Weight 13kg
Dimensions L 180mm W 180mm H 380mm
Compliance Explosion protected to IEC60079 Series
Materials Manganese Bronze / Brass / Aluminium / PTFE
IP Rating IP66

Ordering Procedure

- 1 Select complete Coupler from Table 1
- 2 Select Phase Thimble from Table 2 (3 Required)
- 3 Select Grommet from Table 3
- 4 Select Accessories from Body Size B Accessories

Table 1

Part Number	Description	Colour
AA364T2	300A 1100V Bolted Coupler	Orange
AA314T2	300A 1100V Bolted Coupler	Blue
AA464T2	425A 660V Bolted Coupler	Orange/Silver
AA414T2	425A 1100V Bolted Coupler	Blue/Silver

NB: Coupler supplied with Pilot Thimble

Table 2

Phase Thimble - c/w screw AH009868 1/4" x 2 1/4" skt. head

Part Number	CSA	ID mm	Utilux Die No.
F-201-432	25	8.0	38-92 Cu
F-201-302	35	9.5	38-115 Cu
F-201-303	50	10.5	38-115 Cu
F-201-303-1	70	12.8	38-142 Cu
F-201-304-1	95	14.0	38-165 Cu
F-201-305-1	120	16.0	38-165 Cu
F-201-306-1	150	18.0	38-183 Cu
F-201-307-1	185	21.8	38-231 Cu
F-201-326-1	240	24.2	SOLDER ONLY

NB: CSA is indicative only. Use ID for thimble selection

Table 3

Neoprene Grommets

Part Number	Cable Acceptance mm
4021-25	22.0-25.0
4021-30	24.0-30.0
4021-32	29.0-32.0
4021-34	31.0-34.0
4021-37	33.0-37.0
4021-40	36.0-40.0
4021-43	39.0-43.0
4021-47	42.0-47.0
4021-51	46.0-51.0
4021-54	50.0-54.0
4021-57	53.0-57.0
4021-60	56.0-60.0
4021-64	59.0-64.0
4021-67	63.0-67.0
4021-70	66.0-70.0
4021-76	69.0-76.0
4021-80	75.0-80.0
4021-83	79.0-83.0

Spare Parts

#	Part Number	Description
1A	F-4013-364T	300A 660V Coupler Body c/w items 1A, 4, 10, 11, 12, 13 & 14
1B	F-4013-314T	300A 1100V Coupler Body c/w items 1B, 4, 10, 11, 12, 13 & 14
1C	F-4013-464T	425A 660V Coupler Body c/w items 1C, 4, 10, 11, 12, 13 & 14
1D	F-4013-414T	425A 1100V Coupler Body c/w items 1D, 4, 10, 11, 12, 13 & 14
2A	F-4813	Interior c/w Earth Lugs, Earth Ring, Screws & Pilot Socket Assy
2B	F-4813KIT	Interior Service Kit c/w Insulators & O-rings
3	See Table 3	Neoprene Grommet
4	4014B	Clamping Cap
5	See Table 2	Phase Thimble
6A	F-201-299	300A Phase Socket c/w O-ring AI019013
6B	F-201-300-1	425A Phase Socket c/w O-ring AI019013
7	AH009868	Screw 1/4" x 2 1/4" skt. head
8	F-4819	Pilot Socket Assy c/w O-ring AI019065 & Pilot Thimble
9	F-AH017206B	Earth Lug c/w screw AH115115 & washer AH150014
10	4023	Face Seal
11	AH151039	Screw M10 x 40 button head
12	AH113111	Screw M10 x 16 hex. head
13	AH151011	Spring Washer M10
14	AH150011	Washer M10

CMI Head Office NSW | (02) 9807 6155 | F3, 3-29 Birnie Ave, Lidcombe, NSW, 2141 | nswsales@cmielectrical.com.au

CMI QLD-Brisbane

(07) 3863 0749
485A Zillmere Road,
Zillmere QLD 4034
southqdsales@cmielectrical.com.au

CMI QLD – Rockhampton

(07) 4921 0978
Shop 3 at 76 Hollingsworth Street,
North Rockhampton Qld 4701
northqdsales@cmielectrical.com.au

CMI VIC

(03) 9532 1233
3 Dissik Street,
Cheltenham VIC 3192
vic-sales@cmielectrical.com.au

CMI WA

(08) 9358 1788
36 Division Street,
Welshpool WA 6106
wasa-sales@cmielectrical.com.au